

Series UACPS

Standard Type/Single Acting Spring Return, Spring Extended

Bore Size mm(inch) : $\phi 6(1/4\text{Nom.})$, $\phi 10(3/8\text{Nom.})$, $\phi 16(5/8\text{Nom.})$



- STAINLESS STEEL BODY
- HIGH CYCLE LIFE
- BUMPERS STANDARD
- BUILT - IN MAGNET
- COMPACT LIGHT DESIGN
- MANUFACTURING CERTIFIED TO ISO 9001/9002 STANDARDS

Symbol Single Acting/Single Rod



How to Order

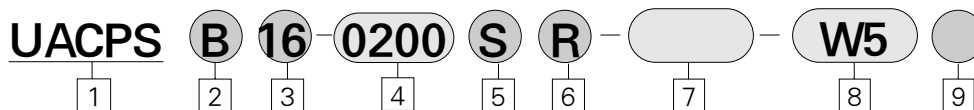

1 Air Cylinder
Built-in magnet, Rubber cushions are standard.

2 Mounting
B : Basic type
L : Axial foot type
F : Rod side flange type
D : Double Clevis type
(Except for $\phi 6$)

3 Bore Size(inch)
6 : $\phi 6(1/4\text{Nom.})$
10 : $\phi 10(3/8\text{Nom.})$
16 : $\phi 16(5/8\text{Nom.})$

4 Stroke/Hundredth of an inch
* For Stroke Refer to page A-32

5 Action
S : Single Acting Spring Return
T : Single Acting Spring Extended

6 Port Location on Head Cover

Symbol	Bore size	
	$\phi 6$	$\phi 10, \phi 16$
R	-	in-line
Blank	in-line	Rear port

7 Special Options

Blank : Standard
XC16 : Copper-free

8 Applicable Auto Switch

Reed Switch
(Band mounted type)
W5 : Reed Switch

* Standard Lead 0.5m(Up to 3m Optional)

9 Number of Switches

Blank : 2 pcs.
S : 1 pc.
N : (n) pcs.

ACP

UACP

AX

AS

AM

AL
ALX

UARD

UAQ

AJ

AG

UAG

ADM

ADR

AMR

UAMR

AST

W~

PART No. of Mounting Bracket

Mounting Bracket	Bore Size(inch)		
	φ 6(1/4 Nom.)	φ 10(3/8 Nom.)	φ 16(5/8 Nom.)
Foot	ACP006-19	ACP010-19	ACP016-19
Flange	ACP006-20	ACP010-20	ACP016-20
※T Mounting	-	ACP010-42B	ACP016-42B

※T Mounting : Double clevis type(D)

PART No. of Auto Switch Mounting Band

Bore Size mm(inch)	PART No. of Auto Switch Mounting Band	Note
φ 6(1/4 Nom.)	ACP006	Common use to all of W5□ types
φ 10(3/8 Nom.)	ACP010	
φ 16(5/8 Nom.)	ACP016	

Standard Type/Single Acting : Single Rod/Series UACPS

Specifications

Action	Spring Return	Spring Extended	
Fluid	Air		
Proof Pressure	149 PSI(1.05MPa)		
Max. Operating Oressure	100 PSI(0.70MPa)		
Min. Operating Pressure	φ 0.24	28 PSI	36 PSI
	φ 0.39, φ 0.63	17 PSI	
Ambient and Fluid Temperature	40~140 ° F (5~60℃)		
Cushion	Rubber cushion (Standard)		
Lubrication	None (Non-Lube)		
Piston Speed	50~750 mm/sec. (2~29.5 in/sec)		

Auto Switch Specifications

Mounting	Bore Size mm(inch)	Reed Switch
		Grommet
Band Mounted Type	φ6(1/4 Nom.), φ10(3/8 Nom.), φ16(5/8 Nom.)	W5 Type

Standard Stroke (inch×100)

Bore Size mm(inch)	Standard Stroke
φ 6(1/4 Nom.)	0050, 0100, 0150, 0200
φ 10(3/8 Nom.)	0050, 0100, 0150, 0200
φ 16(5/8 Nom.)	0050, 0100, 0150, 0200

Spring Retracting Force (lbs)

Bore Size mm(inch)	Extended Position	Retracted Position
φ 6(1/4 Nom.)	0.84	0.40
φ 10(3/8 Nom.)	1.54	0.79
φ 16(5/8 Nom.)	3.20	1.54

Mounting and Accessories

Mounting		Basic Type	Axial Foot Type	Rod Side Flange Type	Double Clevis Type
Standard	Mounting Nut	●	●	●	-
	Rod end Nut	-	-	-	-
	Clevis Pin	-	-	-	●
Option	Single Knuckle Joint	●	●	●	●
	Double Knuckle Joint(with pin)	●	●	●	●
	T Mounting	-	-	-	●

Construction/Parts List

Single Acting/Spring Extended
UACPS□□ - □□□ T

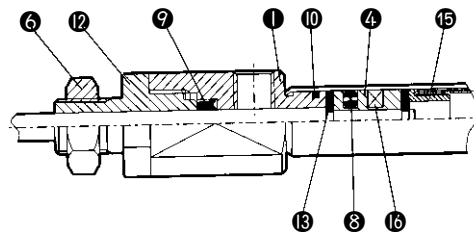
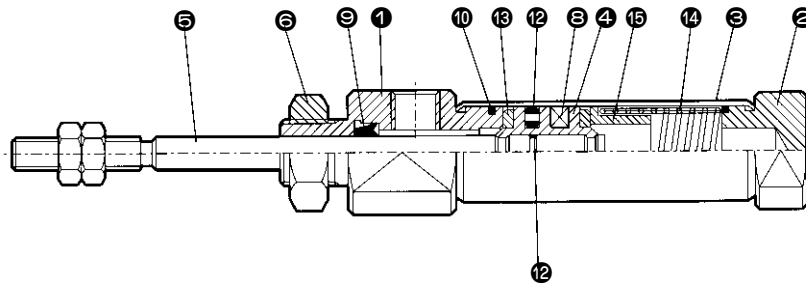

UACPS6 Rod Cover, Piston

Single Acting/Spring Return
UACPS□□ - □□□ S

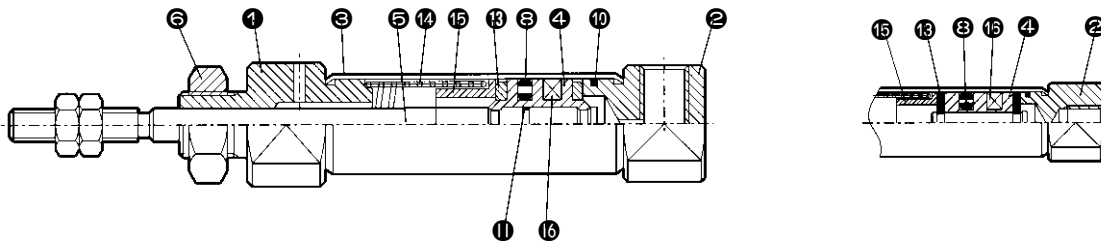

UACPS6 Head cover, Piston

Parts List

No.	Description	Material	Note
①	Rod Cover	Aluminum Alloy	White Alumite
②	Head Cover	Aluminum Alloy	White Alumite
③	Cylinder Tube	Stainless Steel	-
④	Piston	Brass	-
⑤	Piston Rod	Stainless Steel	-
⑥	Mounting Nut	Brass	Nickel Plated
⑧	Piston Packing	NBR	-

Standard Type/Single Acting : Single Rod/Series UACPSB

No.	Description	Material	Note
⑨	Rod packing	NBR	-
⑩	Tube gasket	NBR	-
⑪	Piston gasket	NBR	-
⑫	Packing retainer	Aluminum Alloy	White Alumite
⑬	Bumper	Urethane	-
⑭	Return spring	Piano Wire	-
⑮	Spring seat	Brass	-
⑯	Magnet	-	-

ACP

UACP

AX

AS

AM

AL
ALX

UARD

UAQ

AJ

AG

UAG

ADM

ADR

AMR

UAMR

AST

W~

Series UACPS

Spring Return/Standard Type(UACPSB)

UACPSB Bore Size Stroke S Port location on Head Cover

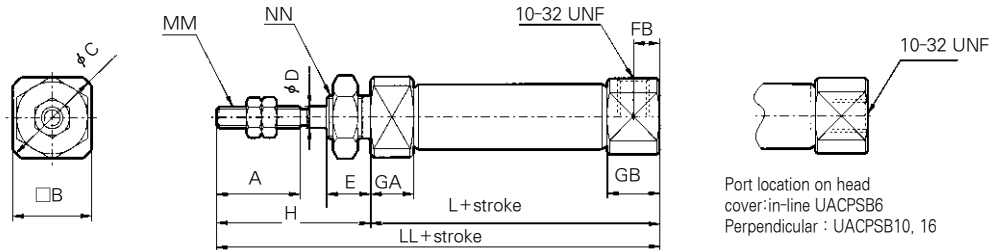

(inch)

Bore size	A	B	C	D	E	FB	H	MM	GA	GB	NN	L				LL			
												5~15 ST	16~30 ST	31~45 ST	46~60 ST	5~15 ST	16~30 ST	31~45 ST	46~60 ST
φ6(1/4 Nom.)	0.59	0.31	0.35	0.12	0.32	-	1.10	No.5-40 UNC	0.12	0.28	1/4-28 UNC	1.56	1.91	2.07	2.62	2.66	3.01	3.17	3.72
φ10(3/8 Nom.)	0.59	0.47	0.55	0.16	0.32	0.20	1.10	No.6-40 UNF	0.22	0.37	5/16-24 UNC	1.83	2.13	2.60	3.07	2.93	3.23	3.70	4.17
φ16(5/8 Nom.)	0.59	0.71	0.79	0.20	0.32	0.20	1.10	No.10-32 UNF	0.22	0.37	3/8-24 UNC	1.81	2.16	2.62	3.09	2.91	3.25	3.72	4.19

Spring Return/Axial Foot Type (UACPSL)

UACPSL Bore Size Stroke S Port Location on Head Cover

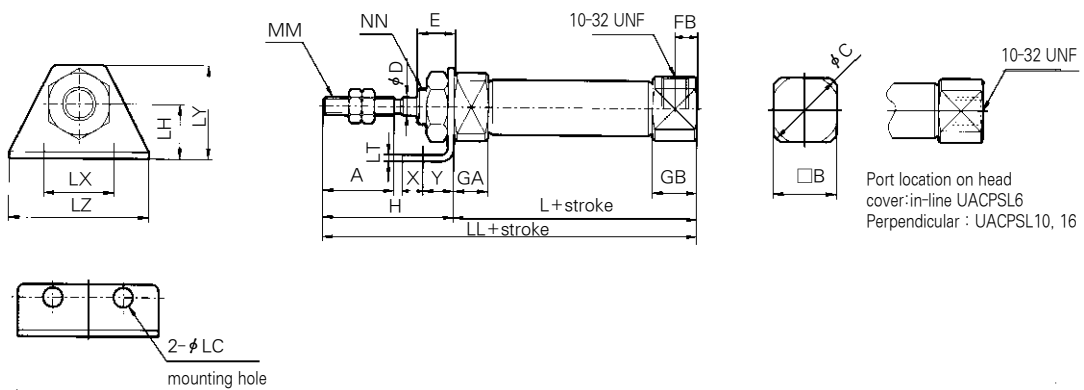

(inch)

Bore size	A	B	C	D	E	FB	H	LC	LH	LT	LX	LY	LZ	MM	GA	GB	NN	X	Y	L				LL			
																				5~15 ST	16~30 ST	31~45 ST	46~60 ST	5~15 ST	16~30 ST	31~45 ST	46~60 ST
φ6(1/4 Nom.)	0.59	0.31	0.35	0.12	0.31	-	1.10	0.18	0.35	0.06	0.95	0.65	1.26	No.5-40 UNC	0.12	0.28	1/4-28 UNF	0.20	0.28	1.56	1.91	2.07	2.62	2.66	3.01	3.17	3.72
φ10(3/8 Nom.)	0.59	0.47	0.55	0.16	0.31	0.20	1.10	0.18	0.35	0.06	0.95	0.65	1.26	No.6-40 UNF	0.22	0.37	5/16-24 UNF	0.20	0.28	1.83	2.13	2.60	3.07	2.93	3.23	3.70	4.17
φ16(5/8 Nom.)	0.59	0.71	0.79	0.20	0.31	0.20	1.10	0.22	0.55	0.09	1.30	0.98	1.65	No.10-32 UNF	0.22	0.37	3/8-24 UNF	0.24	0.35	1.81	2.16	2.62	3.09	2.91	3.25	3.72	4.19

Spring Return/Rod Side Flange Type (UACPSF)

UACPSF Bore Size Stroke S Port location on head cover

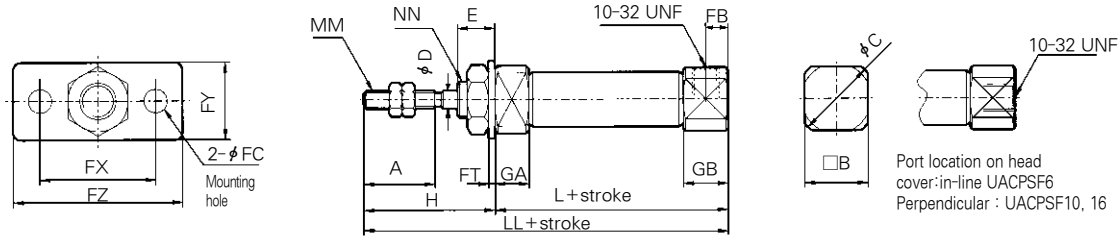

Port location on head cover: in-line UACPSF6
Perpendicular: UACPSF10, 16

(inch)

Bore size	A	B	C	D	E	FC	FT	FX	FY	FZ	FB	H	MM	GA	GB	NN	L				LL			
																	5~15ST	16~30ST	31~45ST	46~60ST	5~15ST	16~30ST	31~45ST	46~60ST
φ6(1/4 Nom.)	0.59	0.32	0.35	0.12	0.31	0.18	0.06	0.95	0.55	1.26	-	1.10	No.5-40 UNC	0.12	0.28	1/4-28 UNF	1.56	1.91	2.07	2.62	2.66	3.01	3.17	3.72
φ10(3/8 Nom.)	0.59	0.47	0.55	0.16	0.31	0.18	0.06	0.95	0.55	1.26	0.20	1.10	No.6-40 UNF	0.22	0.37	5/16-24 UNF	1.83	2.13	2.60	3.07	2.93	3.23	3.70	4.17
φ16(5/8 Nom.)	0.59	0.71	0.79	0.29	0.31	0.22	0.09	1.30	0.78	1.65	0.20	1.10	No.10-32 UNF	0.22	0.37	3/8-24 UNF	1.81	2.16	2.62	3.09	2.91	3.25	3.72	4.19

Spring Return/Double Clevis Type (UACPSD)

UACPSD Bore size Stroke S Port location on head cover

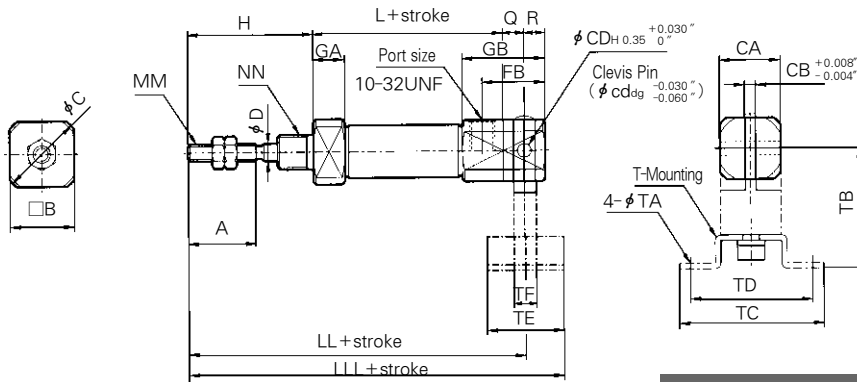

T Mounting (inch)

Bore size	TA	TB	TC	TD	TE	TF
φ 10(3/8 Nom.)	0.18	1.42	1.58	1.26	0.87	0.47
φ 16(5/8 Nom.)	0.22	1.38	1.89	1.50	1.10	0.63

(inch)

Bore size	A	B	C	CA	CB	CD (cd)	D	FB	GA	GB	H	MM	Q	R	L				LL				LLL			
															5~15ST	16~30ST	31~45ST	46~60ST	5~15ST	16~30ST	31~45ST	46~60ST	5~15ST	16~30ST	31~45ST	46~60ST
φ 10(3/8 Nom.)	0.59	0.47	0.55	0.47	0.13	0.13	0.16	0.71	0.22	0.89	1.10	No.6-40 UNF	0.32	0.20	1.83	2.13	2.60	3.07	3.25	3.54	4.02	4.49	3.68	3.98	4.45	4.92
φ 16(5/8 Nom.)	0.59	0.71	0.79	0.71	0.26	0.20	0.20	0.91	0.22	1.08	1.10	No.10-32 UNF	0.39	0.32	1.81	2.16	2.62	3.09	3.31	3.64	4.11	4.59	3.86	4.19	4.67	5.14

ACP

UACP

AX

AS

AM

AL
ALX

UARD

UAQ

AJ

AG

UAG

ADM

ADR

AMR

UAMR

AST

W~

Series UACPS

Spring Extended/Basic Type(UACPSB)

UACPSB Bore size Stroke T

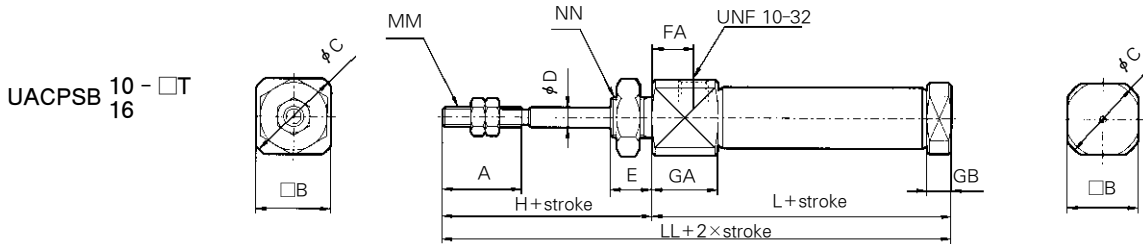
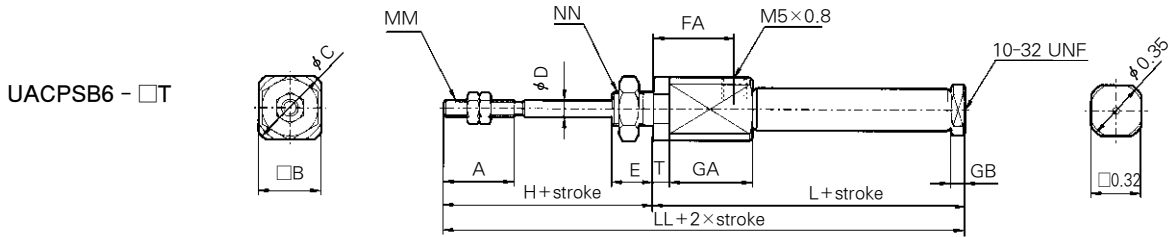

(inch)

Bore size	A	B	C	D	E	FA	H	MM	GA	GB	NDh8	T	NN	L				LL			
														5~15ST	16~30ST	31~45ST	46~60ST	5~15ST	16~30ST	31~45ST	46~60ST
#6(1/4 Nom.)	0.59	0.47	0.55	0.12	0.31	0.57	1.10	No.5-40 UNC	0.63	0.12	0.24 ⁰ _{-0.018}	0.12	1/4-28 UNF	2.03	2.38	2.54	3.09	3.13	3.48	3.64	4.19
#10(3/8 Nom.)	0.59	0.47	0.55	0.16	0.31	0.20	1.10	No.6-40 UNF	0.49	0.22	0.32 ⁰ _{-0.022}	-	5/16-24 UNF	1.95	2.24	2.72	3.19	3.05	3.35	3.82	4.29
#16(5/8 Nom.)	0.59	0.71	0.79	0.20	0.31	0.20	1.10	No.10-32 UNF	0.49	0.22	0.39 ⁰ _{-0.022}	-	3/8-24 UNF	1.93	2.26	2.74	3.21	3.03	3.37	3.84	4.31

Spring Extended/Axial Foot Type(UACPSL)

UACPSL Bore size Stroke T

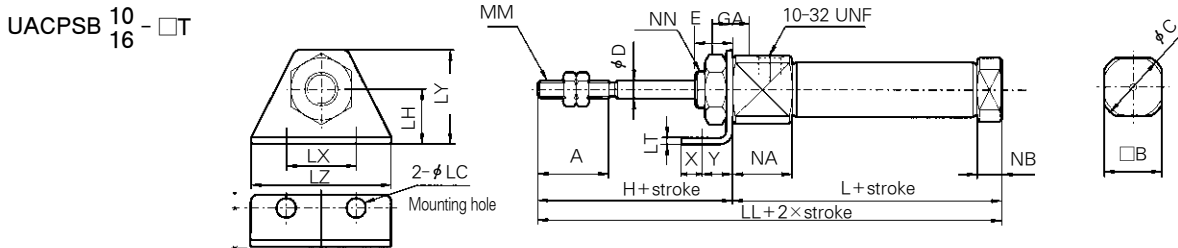
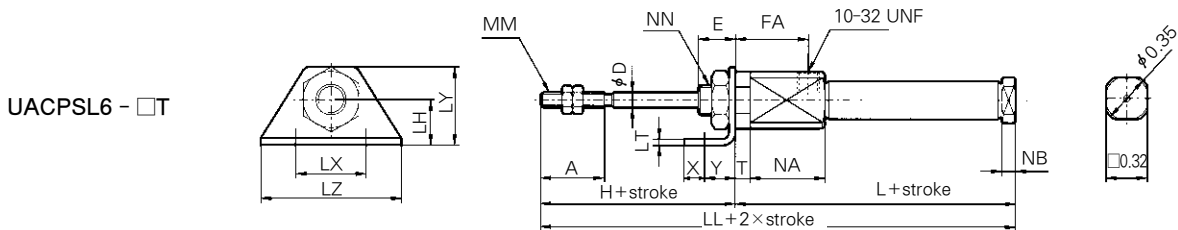

(inch)

Bore size	A	B	C	D	E	GA	H	LC	LH	LT	LX	LY	LZ	MM	NA	NB	T	X	Y	NN	L				LL			
																					5~15ST	16~30ST	31~45ST	46~60ST	5~15ST	16~30ST	31~45ST	46~60ST
#6(1/4 Nom.)	0.59	0.47	0.55	0.12	0.31	0.57	1.10	0.18	0.35	0.06	0.95	0.65	1.26	No.5-40 UNC	0.63	0.12	0.12	0.20	0.28	1/4-28 UNF	2.03	2.38	2.54	3.09	3.13	3.48	3.64	4.19
#10(3/8 Nom.)	0.59	0.47	0.55	0.16	0.31	0.32	1.10	0.18	0.35	0.06	0.95	0.65	1.26	No.6-40 UNF	0.49	0.22	-	0.20	0.28	5/16-24 UNF	1.95	2.24	2.72	3.19	3.05	3.35	3.82	4.29
#16(5/8 Nom.)	0.59	0.71	0.79	0.20	0.31	0.32	1.10	0.22	0.55	0.09	1.30	0.98	1.65	No.10-32 UNF	0.49	0.22	-	0.24	0.35	3/8-24 UNF	1.93	2.26	2.74	3.21	3.03	3.37	3.84	4.31

Spring Extended/Rod Side Flange Type (UACPSF)

UACPSF **Bore Size** **Stroke** T

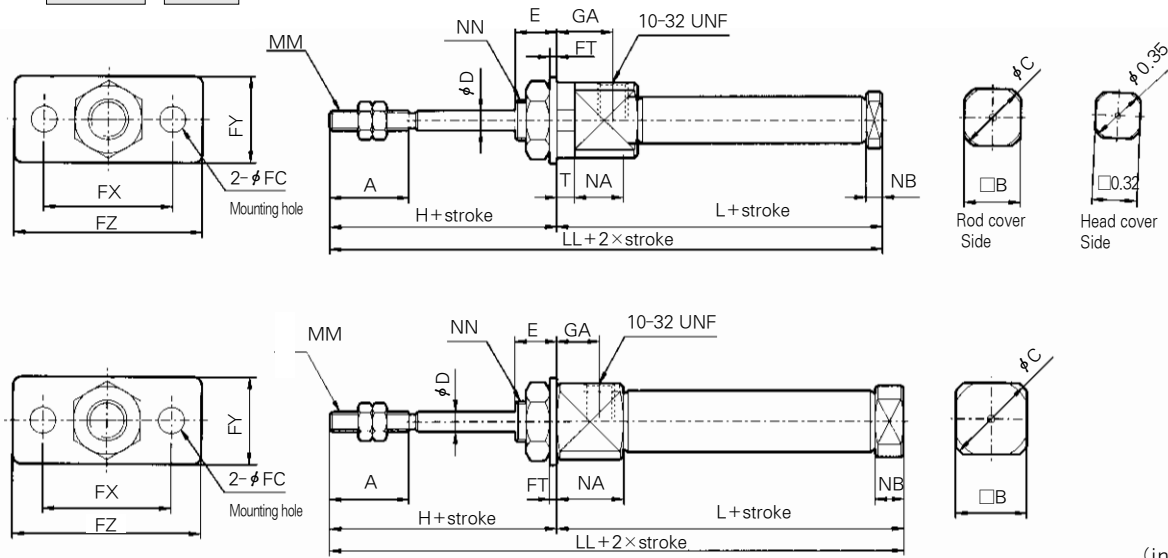

Bore size	A	B	C	D	E	FC	FT	FX	FY	FZ	GA	H	MM	NA	NB	T	NN	L				LL			
																		5~15ST	16~30ST	31~45ST	46~60ST	5~15ST	16~30ST	31~45ST	46~60ST
φ6(1/4 Nom.)	0.59	0.47	0.55	0.12	0.31	0.18	0.06	0.95	0.55	1.26	0.57	1.10	No.5-40 UNF	0.24	0.12	0.12	1/4-28 UNF	2.03	2.38	2.54	3.09	3.13	3.48	3.64	4.19
φ10(3/8 Nom.)	0.59	0.47	0.55	0.16	0.31	0.18	0.06	0.95	0.55	1.26	0.32	1.10	No.6-40 UNF	0.49	0.22	-	5/16-24 UNF	1.95	2.24	2.72	3.19	3.05	3.35	3.82	4.29
φ16(5/8 Nom.)	0.59	0.71	0.79	0.20	0.31	0.22	0.09	1.30	0.79	1.65	0.32	1.10	No.10-32 UNF	0.49	0.22	-	3/8-24 UNF	1.93	2.26	2.74	3.21	3.03	3.37	3.84	4.31

Spring Extended/Double Clevis Type (UACPSD)

UACPSD **Bore size** **Stroke** T

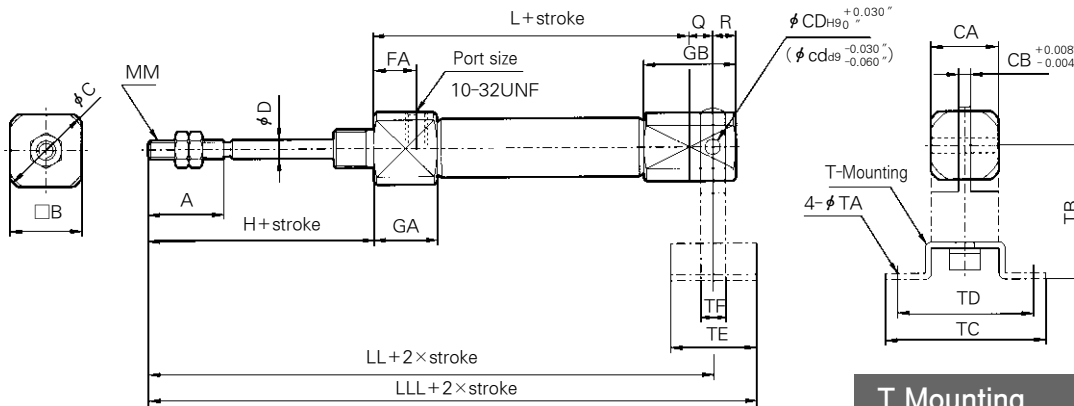

T Mounting						
Bore size	TA	TB	TC	TD	TE	TF
φ10(3/8 Nom.)	0.18	1.14	1.58	1.26	0.87	0.47
φ16(5/8 Nom.)	0.22	1.38	1.89	1.50	1.10	0.63

Bore size	A	B	C	CA	CB	CD (cd)	D	FB	GA	GB	H	MM	Q	R	L				LL				LLL			
															15~15ST	16~30ST	31~45ST	46~60ST	15~15ST	16~30ST	31~45ST	46~60ST	15~15ST	16~30ST	31~45ST	46~60ST
φ10(3/8 Nom.)	0.59	0.47	0.55	0.47	0.13	0.13	0.16	0.32	0.49	0.89	1.10	No.6-40 UNF	0.32	0.20	2.11	2.40	2.87	3.35	3.52	3.82	4.29	4.76	3.96	4.25	4.72	5.20
φ16(5/8 Nom.)	0.59	0.71	0.79	0.71	0.26	0.20	0.20	0.32	0.49	1.08	1.10	No.10-32 UNF	0.39	0.32	2.09	2.42	2.89	3.37	3.58	3.92	4.39	4.86	4.13	4.47	4.94	5.41

- ACP
- UACP**
- AX
- AS
- AM
- AL
- ACX
- UARD
- UAQ
- AJ
- AG
- UAG
- ADM
- ADR
- AMR
- UAMR
- AST
- W~