

Series DP300/3000/5000

3 · 5 Port Air Pilot Valve



- COMPACT SIZE AND LIGHT WEIGHT
 - 0.63 inch Width (Series UDP300, UDP3000)
 - 1.26 inch Width (Series UDP5000)
- LARGE FLOW CAPACITY
 - Cv. 1.0 - NPT 1/4" (Series UDP300, UDP3000)
 - Cv. 3.2 - NPT 1/2" (Series UDP5000)

Symbol

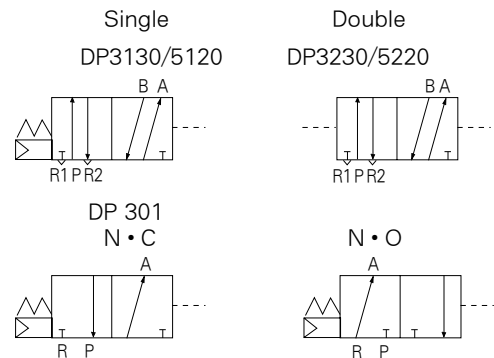

How to Order

DP3000

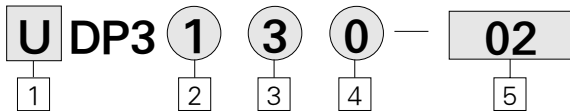

- | | |
|--|--|
| <p>1 Series DP3000
Blank : Metric (PT)
U : NPT (UNF)</p> <p>2 Type of Actuation
1 : Single Pilot type
2 : Double Pilot type</p> <p>3 Body Type
3 : For 30 type Manifold
(Body Ported)</p> | <p>4 Body Specifications
0 : Standard</p> <p>5 Port Size (P, A, B)
01 : 1/8"
02 : 1/4"
※ Exhaust Port is only 1/8"</p> |
|--|--|

DP5000

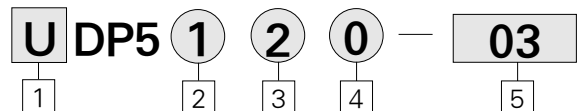

- | | |
|--|--|
| <p>1 Series DP5000
Blank : Metric (PT)
U : NPT (UNF)</p> <p>2 Type of actuation
1 : Single pilot type
2 : Double pilot type</p> <p>3 Body Type
2 : For 20 type Manifold
(Body Ported)</p> | <p>4 Body Specifications
0 : Standard</p> <p>5 Port Size (P, A, B)
03 : 3/8"
04 : 1/2"
※ Exhaust Port is only 3/8"</p> |
|--|--|

DP300

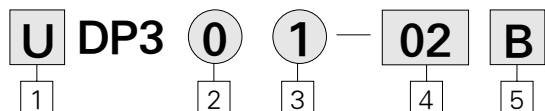

- | | | | |
|--|---|---|---|
| <p>1 Series DP300
Blank : Metric (PT)
U : NPT (UNF)</p> | <p>2 Type of Actuation
0 : N · C / N · O</p> | <p>3 Body Type
1 : Body Ported</p> | <p>4 Port size (P, A, R)
01 : 1/8"
02 : 1/4"</p> |
|--|---|---|---|

Specifications

Fluid	Air		
Operating Pressure Range	2 Position	Single	21~128 PSI {0.15~0.9 Mpa}
		Double	14~128 PSI {0.1~0.9 Mpa}
Ambient and Fluid Temperature	MAX. 140° F(60° C)		
Pilot Pressure Range	2 Position	Single	^(Note2) 24~128 PSI {0.16~0.9 Mpa}
		Double	14~12 8PSI {0.1 ~ 0.9 Mpa}
Lubrication	Not required		
Impact/Vibration Resistance	30G / 5G (8.3 ~ 2000Hz)		
Mounting Position	Free		
(Note 1) Effective Orifice mm ² (Cv factor)	1/8 "	14 (1.0)	
	1/4 "	17.5 (1.0)	
	3/8 "	48 (2.7)	
	1/2 "	56 (3.1)	
Pilot Port Size	1/8 " Common use		

(Note 1) Cv-Capacity Co-efficients(Flow Factors)

(Note 2) The minimum pressure for PILOT should be higher than "A"

P : Supply pressure. A : (0.5×P+1) {0.5×P+0.1}

* cm² = 0.0016 in²

Model

Piping	Type	Position/Solenoid	Port size	Effective orifice mm ² (Cv factor)	
Body Ported	DP3130	2 Position Single	1/8 "	1/8 "	1/4 "
			1/4 "	14 (0.8)	18 (1.0)
	DP3230	2 Position Double	1/4 "	14 (0.8)	18 (1.0)
			3/8 "	3/8 "	1/2 "
DP5120	2 Position Single	1/2 "	48 (2.8)	58 (3.2)	
		DP5220	2 Position Double	48 (2.8)	56 (3.2)

DV1000 · 3000 · 4000

DV2000

DS2000

DS3000

DS5000

DS6000

DX2

DV100

DS300

DW

DP300 · 3000 · 5000

DM

DH

3 Port

inch(mm)

DP 301-01
02

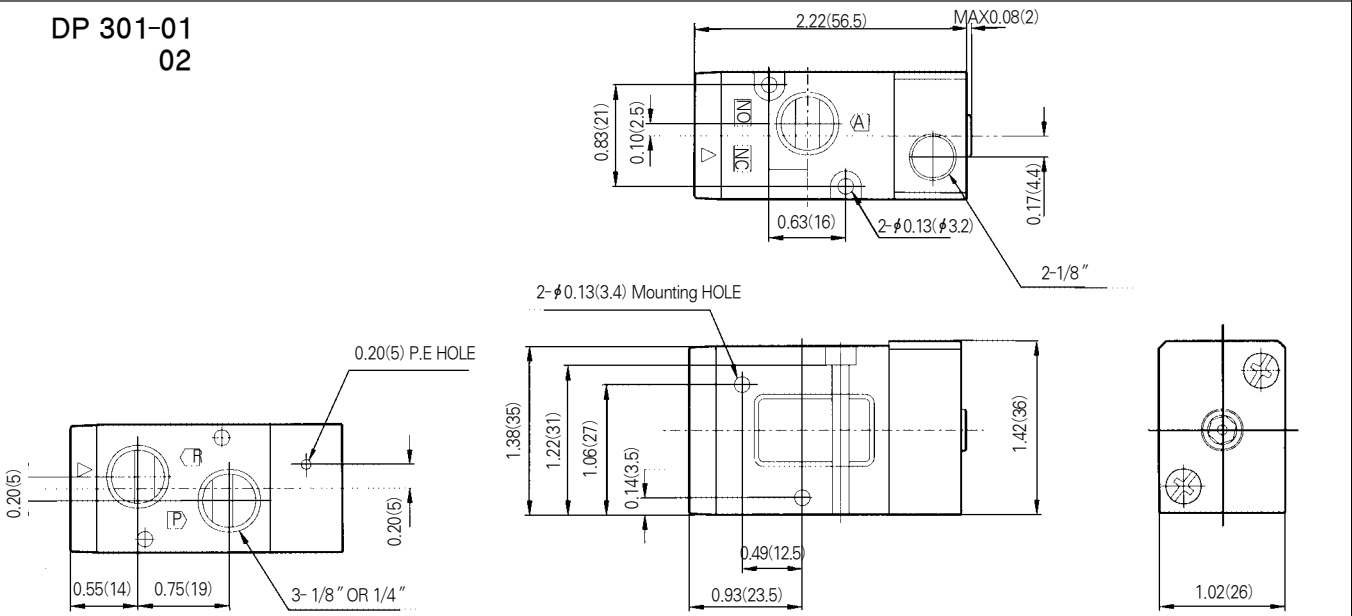

Series DP300/3000/5000

5 Port/2 Position Single, Double

inch(mm)

DP3130-01
02

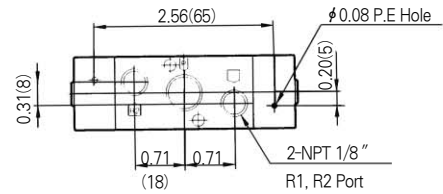
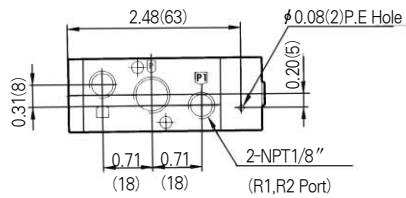
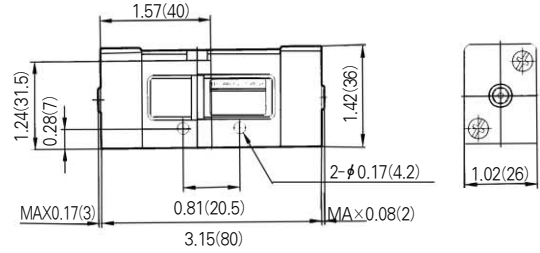
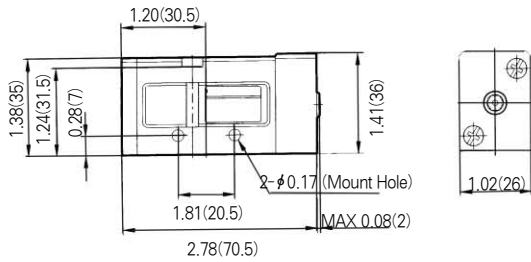
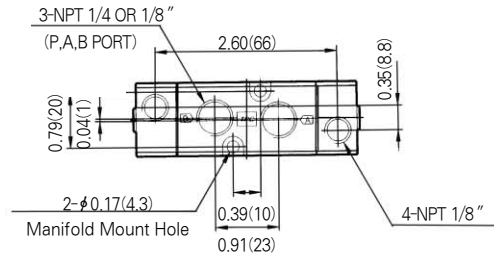
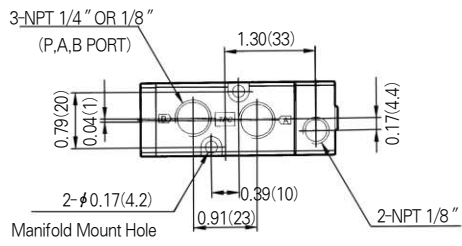

5 Port/2 Position Single, Double

inch(mm)

DP5120-03
04

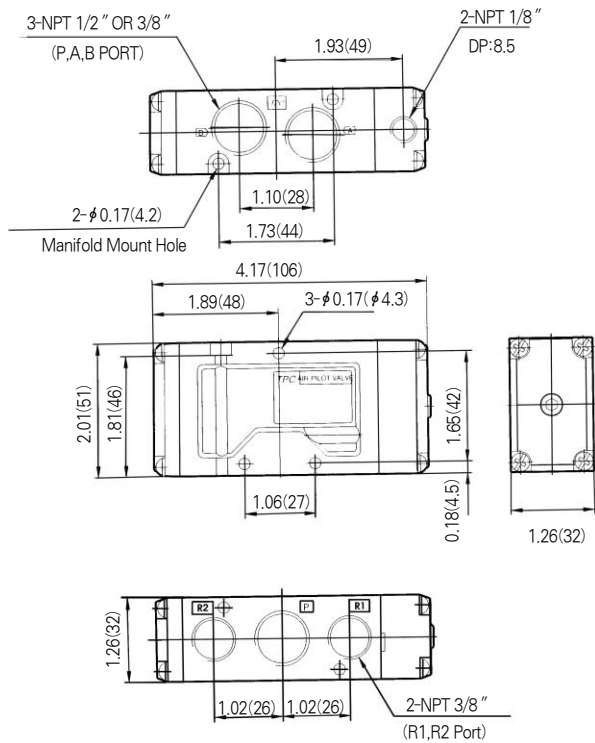

DP5220

